

SCARD

**Society of Chairmen of
Academic Radiology
Departments**

NEW AND PROSPECTIVE CHAIR ORIENTATION

**October 4 - 5, 2007
12:30 pm – 5:00 pm
Van Horne Ballroom C**

**The Fairmont Banff Springs
Banff, Alberta, Canada**

SCARD

NEW AND PROSPECTIVE CHAIR ORIENTATION

Hotel Map

Final Program

Faculty List

Attendee List

Notes

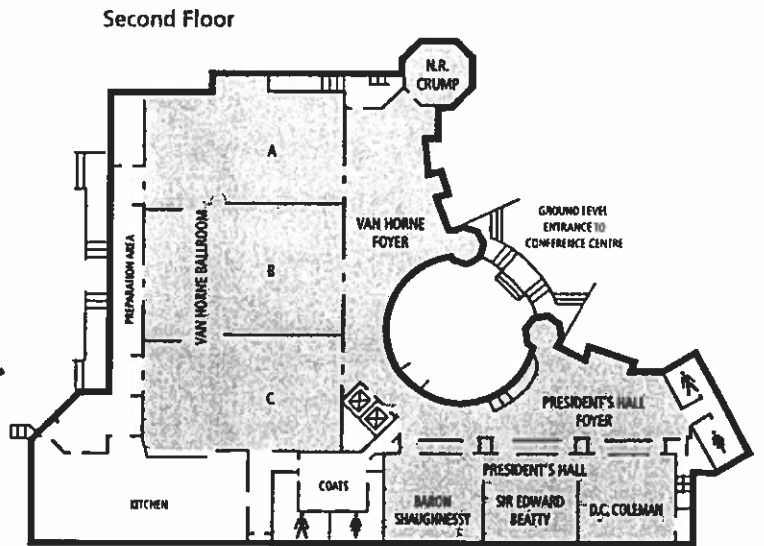
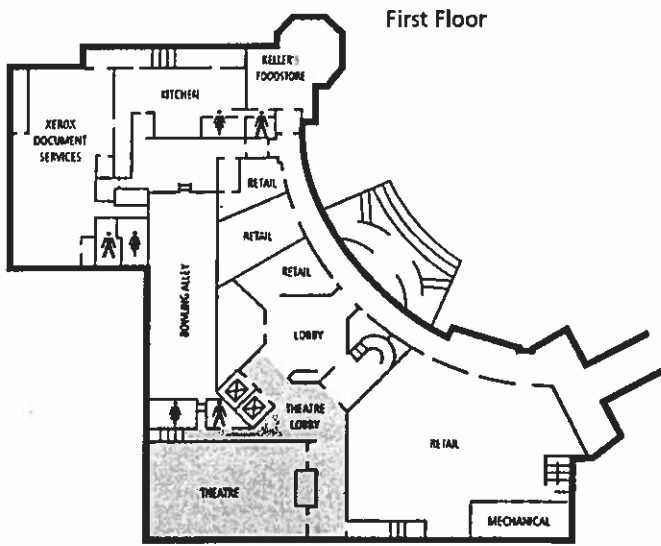

CONFERENCE CENTER

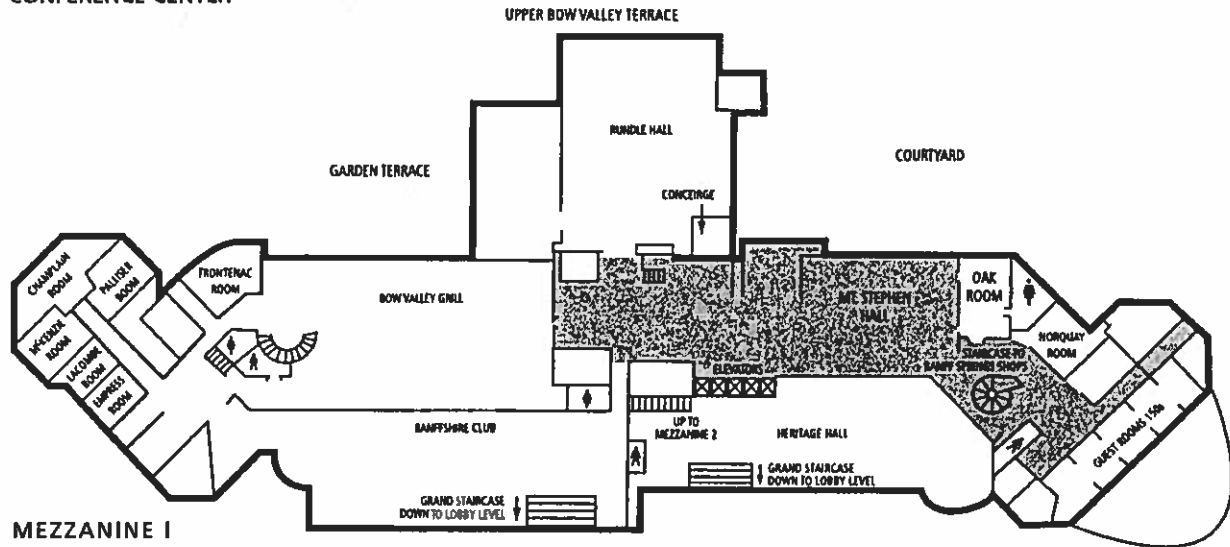

MEZZANINE I

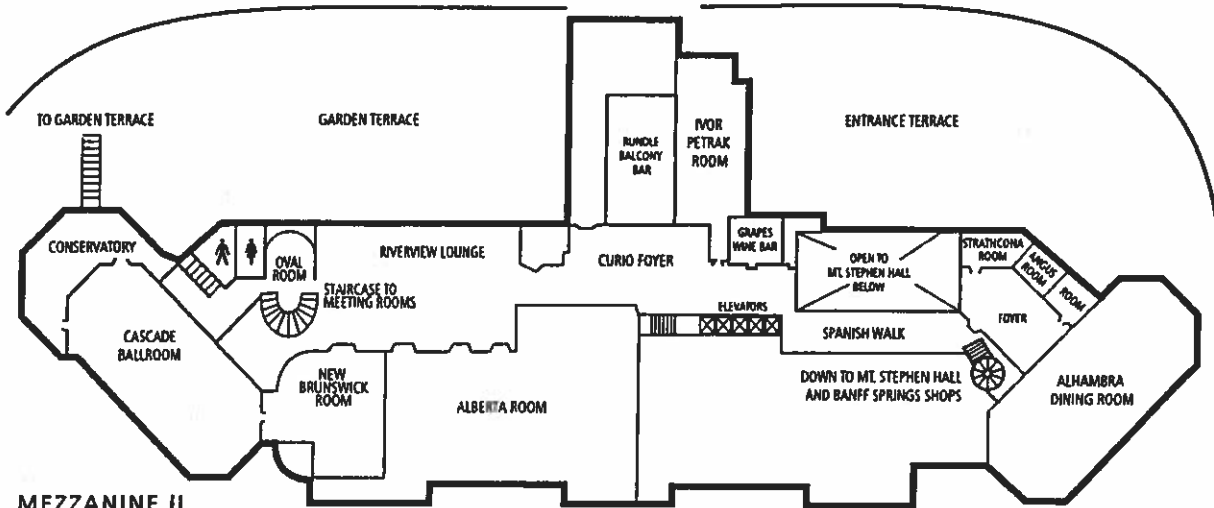

MEZZANINE II

Society of Chairmen of Academic Radiology Departments

NEW AND PROSPECTIVE CHAIR ORIENTATION

The Fairmont Banff Springs, Banff, Alberta, Canada

October 4 – 5, 2007

In joint sponsorship with the Radiological Society of North America

Accreditation and Designation Statement

This activity has been planned and implemented in accordance with the Essential Areas and policies of the Accreditation Council for Continuing Medical Education (ACCME) through the joint sponsorship of the Radiological Society of North America (RSNA) and the Society of Chairmen of Academic Radiology Departments (SCARD). The RSNA is accredited by the ACCME to provide continuing medical education for physicians.

The RSNA designates this educational activity for a maximum of 8.0 *AMA PRA Category 1 Credits™*. Physicians should only claim credit commensurate with the extent of their participation in the activity.

Evaluation

In compliance with the ACCME requirements, you must record your attendance and evaluate the sessions you attend in order to receive AMA PRA Category 1 Credit.

The evaluation instrument is supplied to you at registration in a booklet format. The session evaluations appear in chronologic order. Please write your name, address, and degree(s) in the space provided, and complete the evaluations for the sessions you attend. At the end of the meeting, submit this completed evaluation booklet to the SCARD registration desk. A record of the CME credit earned at this meeting will be mailed to you six to eight weeks after the meeting.

Content Codes

To better help the participants of this AMA PRA Category 1 Credit activity organize their CME records, two-letter content codes will be indicated in the evaluation booklet.

Target Audience

This two-day course is designed for newly appointed chairs (less than two years), for senior faculty who aspire to become chair of an academic radiology department, for junior faculty curious to know more about what a chair's responsibilities encompass, and for chief residents who aspire to leadership in their career.

Learning Objectives

At the completion of this meeting participants should be able to:

- Understand the strategic imperatives affecting the position of radiology chairs.
- Be aware of research initiatives and tactics at the local and national level.
- Become familiar with methodologies and principles affecting the capturing, retention, and expansion of clinical income.
- Learn about the impress of new regulations on the chair's freedom of action and attention to departmental protection
- Gain insight into the stratagems for program and faculty development.

Disclosure Statements

The Accreditation Council for Continuing Medical Education requires the RSNA, as an accredited provider of continuing medical education, to obtain signed disclosure statements from faculty (ie, Board members, committee members, program planners, presenters) for the SCARD Fall Meeting and New and Prospective Chair Orientation programs. The intent of this policy is not to prevent an individual with a financial relationship from participating; however, in accordance with ACCME standards, the RSNA has developed policies and procedures to manage identified conflicts of interest. The ACCME further requires that the RSNA provide disclosure information to all attendees prior to the educational activity. Faculty who have or have had within the previous 12 months (or at the time the research was conducted) an affiliation or financial relationship with any commercial interest are noted with a star (*) after their name in the program book. Financial disclosure statements for these individuals are reported after each individual's name in the disclosure index. All other faculty have indicated they have nothing to disclose.

 This icon indicates discussion of uses not approved by the FDA. The RSNA and SCARD recognize that at scientific meetings faculty may discuss the application of some devices, materials, or pharmaceuticals that are not FDA approved. In keeping with the highest standards of professional integrity and ethics, RSNA and SCARD require that faculty fully disclose to their audience that there will be discussion of the unlabeled use of a commercial product, device, or pharmaceutical that has not been approved for such purpose by the FDA.

Society of Chairmen of Academic Radiology Departments
NEW AND PROSPECTIVE CHAIR ORIENTATION
The Fairmont Banff Springs, Banff, Alberta, Canada
October 4 – 5, 2007

Program Schedule (current as of 9/12/2007)

Thursday, October 4

7:00 AM – 5:00 PM
Registration

12:30 PM – 1:30 PM
Leadership
AMA PRA Category 1 Credit: 1.00

Stephen R. Baker, MD

Learning Objectives: Acquaint the prospective or new chair with strategic goals common to all leaders of academic radiology departments. Describe the dynamics of the devolution of responsibility among chairs of radiology, medical directors, and deans.

1:30 PM – 2:00 PM
Contracting
AMA PRA Category 1 Credit: 0.50

*Ronald L. Arenson, MD**

Learning Objectives: Learn about billing organizations and medical group structures. Study relationships with medical centers, including joint ventures. Consider patient mix implications for billing and contracting.

2:00 PM – 2:30 PM
Compensation Plan
AMA PRA Category 1 Credit: 0.50

*Ronald L. Arenson, MD**

Learning Objectives: Determine what constitutes a good compensation plan. Learn what types of incentives are important and meaningful. Balance recruitment needs and retention needs, determine fairness. Determine if on-call work should receive additional remuneration.

Thursday, October 4 (continued)

2:30 PM – 2:45 PM

Break

2:45 PM – 3:30 PM

Time Management

AMA PRA Category 1 Credit: 0.75

*Valerie P. Jackson, MD**

Learning Objectives: 1. Describe the advantages of organization and appropriate management of time. 2. Understand methods to gain control over your life. 3. Understand the development of short term and long term goals.

3:30 PM – 4:15 PM

Communication Skills: Strategies for Effective Critical Conversations

AMA PRA Category 1 Credit: 0.75

*Jonathan S. Lewin, MD**

Learning Objectives: 1. To define a useful framework for critical communication. 2. To describe communication skills that are central to successful conflict resolution. 3. To learn concepts and techniques for successful discussion of difficult topics and effective critical communication

4:15 PM – 5:00 PM

How to Protect Your Staff

AMA PRA Category 1 Credit: 0.75

Stephen R. Baker, MD

Learning Objectives: To acquaint the attendee with the need to develop a relationship with non-physician members of your department. To develop channels of communication with staff members allowing for prompt interchange. To use administrative human resources principles to protect your staff. To utilize the concept of apology for conflict resolution

Friday, October 5

7:00 AM – 5:00 PM
Registration

12:30 PM – 1:30 PM
Challenges to a Leader: Eight Case Studies
AMA PRA Category 1 Credit: 1.00

Stephen R. Baker, MD

Learning Objectives: To offer a mechanism for interactive discussions on a case-based format of issues pertinent to leadership by a radiology chairman. To raise issues through such discussions about human resources and equipment resources pertinent to a chairman. To reinforce through didactic exchange salient features important for leaders to acknowledge, if not accept, with respect to motivating and managing faculty.

1:30 PM – 2:15 PM
Turf Management
AMA PRA Category 1 Credit: 0.75

*Norman J. Beauchamp Jr, MD, MHS**

2:15 PM – 2:30 PM
Break

2:30 PM – 3:00 PM
How Do We Motivate Junior Faculty?
AMA PRA Category 1 Credit: 0.50

*Steven E. Seltzer, MD**

Learning Objectives: By attending this seminar, the participant will gain insight into: 1. Factors that affect Radiologists' career choices. 2. Factors that can make an academic practice more desirable. 3. Tactics that a Department Chair can use to help junior faculty in their professional development journey.

Friday, October 5 (continued)

3:00 PM – 4:00 PM

Faculty Discipline: How to Fire Someone

AMA PRA Category 1 Credit: 1.00

Stephen R. Baker, MD

Learning Objectives: Describe the limitations of the chair's range of action with respect to non-renewal and firing of employees. Present the various state and federal regulations with respect to employee rights. Offer a tactical guide for the removal of inept or recalcitrant faculty.

4:00 PM – 4:30 PM

Questions to Faculty

AMA PRA Category 1 Credit: 0.50

*Ronald L. Arenson, MD**

Stephen R. Baker, MD

*Norman J. Beauchamp Jr, MD, MHS**

*Valerie P. Jackson, MD**

*Jonathan S. Lewin, MD**

*Steven E. Seltzer, MD**

Program Adjourns

Faculty List

Program Chair

Stephen R. Baker, MD
UMDNJ-New Jersey Medical School
Newark, NJ

Faculty

Ronald L. Arenson, MD
University of California San
Francisco
San Francisco, CA

Jonathan S. Lewin, MD
Johns Hopkins Hospital
Baltimore, MD

Norman J. Beauchamp Jr, MD
University of Washington HSC
Seattle, WA

Steven E. Seltzer, MD
Brigham & Women's Hospital
Boston, MA

Valerie P. Jackson, MD
Indiana University School of Medicine
Indianapolis, IN

Disclosure Index

Arenson, Ronald L.
Review Board, General Electric Company

Beauchamp, Norman J., Jr
Departmental research grant, Koninklijke Philips; Electronics NV;
Departmental research grant, General Electric Company

Jackson, Valerie P.
Scientific Advisory Board, Hologic, Inc

Lewin, Jonathan S.
Consultant, Interventional Imaging, Inc; Stockholder, Interventional
Imaging, Inc

Seltzer, Steven E.
Radiology Advisory Board, General Electric Company; Board of
Reivew, GE-AUR Radiology Research Academic Fellowship
(GERRAF) program

**2007 New & Prospective Chair Orientation Program
Pre-Registration List
(As of 9/12/07)**

Leonard Bok, MD, MBA
Dept of Radiology
Louisiana State University HSC
2020 Gravier St
New Orleans LA 70112
Office: 504-568-4647
Fax: 504-568-8955
Email: lbok@lsuhsc.edu

Marc A. Borge, MD
Dept of Radiology
Loyola University Medical Center
2160 S 1st Ave
Maywood IL 60153
Office: 708-216-8932
Fax: 708-216-0899
Email: mborge@lumc.edu

Christine Capitan, MBA
1515 Holcombe Blvd Box 057
Houston TX 77030
Office: 713-794-1550
Fax: 713-745-1837
Email: ccapitan@mdanderson.org

Giovanna Casola, MD
St. Joseph Hospital & Medical Center
350 W Thomas Rd
Phoenix, AZ 85013
Office: 602-406-4376
Fax: 602-406-2340

Raymond S. Dougherty, MD
Dept of Radiology
University of California Davis
Ste 3100
4860 Y St
Sacramento CA 95817
Office: 916-734-5309
Fax: 916-734-8490
Email:
raymond.dougherty@ucdmc.ucdavis.edu

Janette D. Durham, MD
Dept of Radiology
University of Colorado HSC
MS C276
12401 E 17th Ave
Aurora CO 80045
Office: 720-848-6608
Fax: 720-848-7513
Email: janette.durham@uchsc.edu

Allen DeVaney Elster, MD
Dept of Radiologic Sciences
Wake Forest Univ School of Medicine
Medical Center Blvd
Winston-Salem NC 27157-1088
Office: 336-716-3294
Fax: 336-713-4267
Email: aelster@wfubmc.edu

Joseph Hise, MD
Baylor University Medical Center
3500 Gaston Ave
Dallas TX 75225
Office: 214-820-3219
Fax: 214-820-7437
Email: hise@swbell.net

Gregory L. Katzman, MD, MBA
20619 E Sandhill Dr
Galveston TX 77554
Office: 409-747-0100
Fax: 409-772-8219
Email: gkatzman@utmb.edu

Dennis Kay, MD
Dept of Radiology
Ochsner Health System
1514 Jefferson Hwy
New Orleans LA 70121
Office: 504-842-3470
Fax: 504-842-7372
Email: dkaymd@aol.com

2007 New & Prospective Chair Orientation Program
Pre-Registration List
(As of 9/12/07)

Lisa H. Lowe, MD
Dept of Radiology
University of Missouri Kansas City
2401 Gillham Rd
Kansas City MO 64108
Office: 816-932-2237
Fax: 816-983-6912
Email: lhlowe@cmh.edu

Elizabeth Lozano
Dept of Radiology
University of Colorado at Denver & Health
Sciences Center
C276, PO Box 6511
Aurora, Co 80045
Office: 720-848-6611
Fax: 720-848-7315
Email: beth.lozano@uchsc.edu

Deborah MacFarlane, MBA
University of California San Diego
28224
200 W Arbor
San Diego CA 92103
Office: 619-543-5701
Fax: 619-471-9331
Email: dmacfarlane@ucsd.edu

Matthew Anthony Mauro, MD
Dept of Radiology
Univ of North Carolina School of Med
Campus Box 7510, 2006 Old Clinic Bldg
101 Manning Dr
Chapel Hill NC 27599-7510
Office: 919-966-4238
Fax: 919-966-9677
Email: m_mauro@med.unc.edu

Jason Mitchell, MD
UMDNJ-New Jersey Medical School
Dept of Radiology
150 Bergen St
Newark, NJ 07103
Office: 973-972-5188
Fax: 973-972-7429
Email: mitchej@umdnj.edu

M. Elizabeth Oates, MD
Dept of Diagnostic Radiology
University of Kentucky
HX - 307B, 800 Rose St
Lexington KY 40536-0293
Office: 859-323-1387
Fax: 859-323-2510

Janelle Petscavage, MD
Dept of Radiology
UMDNJ-New Jersey Medical School
150 Bergen St
Newark NJ 07103
Office: 973-972-5188
Fax: 973-972-7429
Email: jopa905@gmail.com

Victor Joseph Scarmato, MD
Dept of Radiology
Nassau University Medical Center
2201 Hempstead Tpk
East Meadow NY 11554
Office: 516-572-6633
Fax: 516-572-5941
Email: vsarmat@numc.edu

Sherri Stone, MBA
University of California, Davis
4860 Y Street
Acc Suite 3100
Sacramento CA 95817
Office: 916-734-3688
Fax: 916-734-8490

2007 New & Prospective Chair Orientation Program
Pre-Registration List
(As of 9/12/07)

E. Kent Yucel, MD
Dept of Radiology
Tufts New England Medical Center
NEMC 299
750 Washington St
Boston MA 02111
Office: 617-636-0040
Fax: 617-636-0041
Email: kyucel@tufts-nemc.org
